

INSTALLATION INSTRUCTION

When the pitch against a sidewall
About flashing around a sidewall

Pay attention about fixing in the
last cutting raw of shingles.

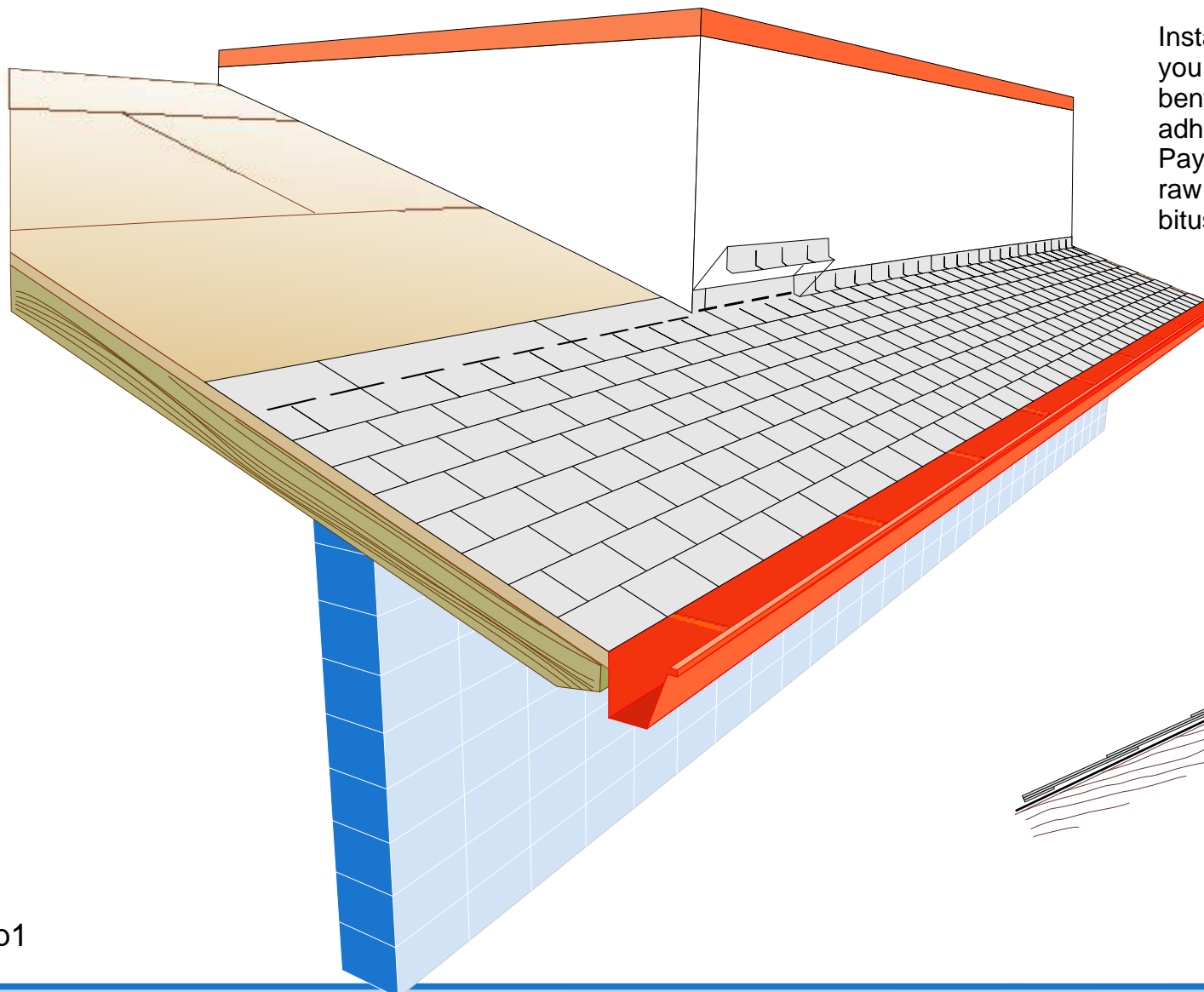

Installed the shingles and when you arrived against a sidewall, bent and fix them with high adherence nails also on the wall. Pay attention about the last cutting raw of shingles; if is necessary use bitustick.

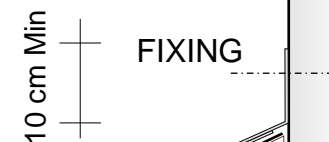

INSTALLATION INSTRUCTION

When the pitch against a sidewall
About flashing around a sidewall

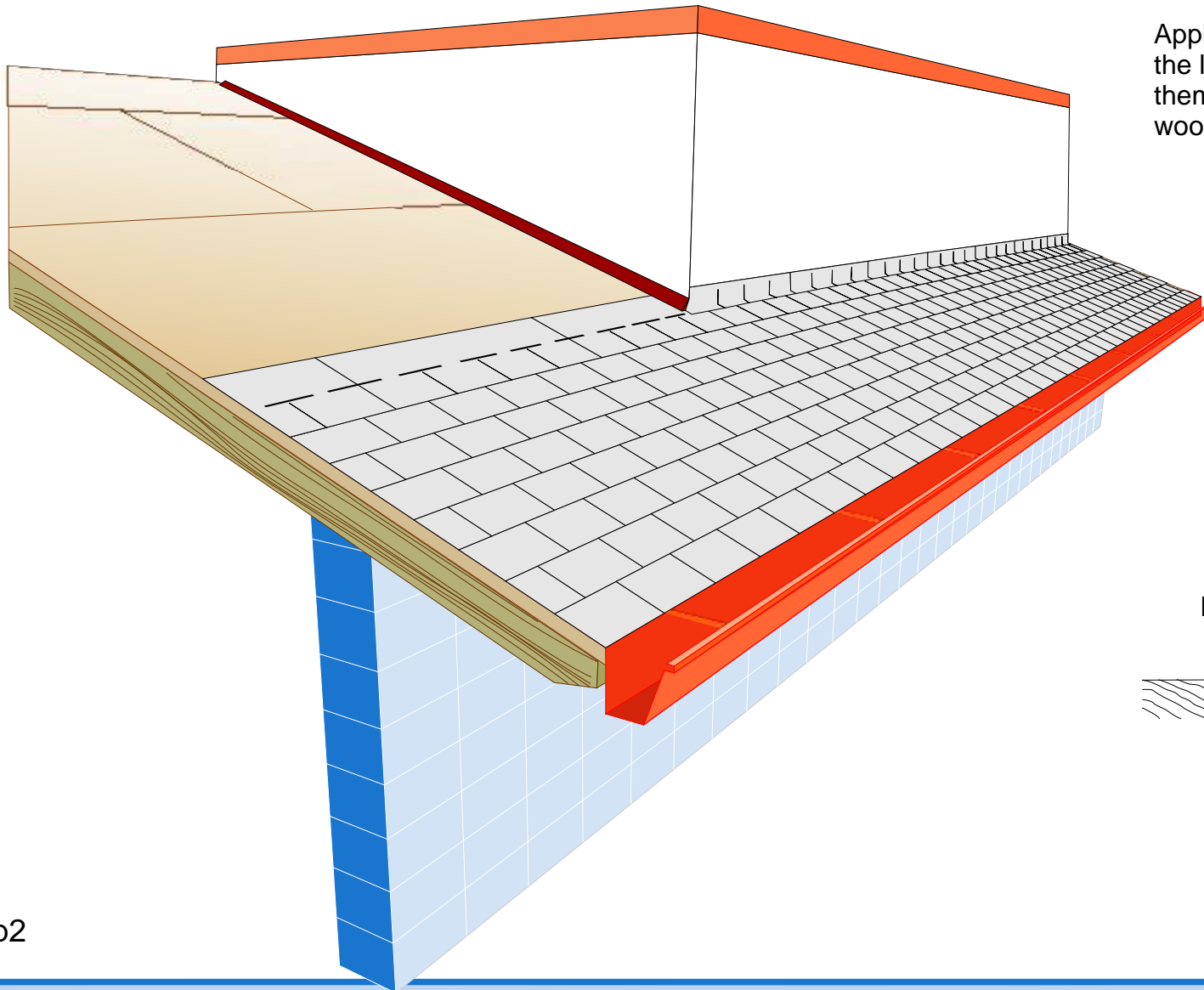

Apply a triangular battens along the lateral side of the wall and fix them with self-tapping screws for wood or screws anchor.

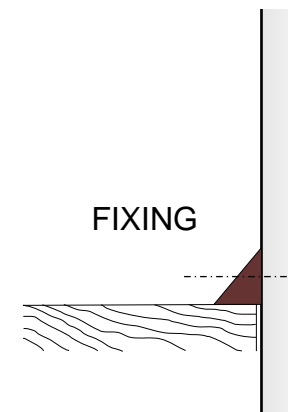

INSTALLATION INSTRUCTION

When the pitch against a sidewall
About flashing around a sidewall

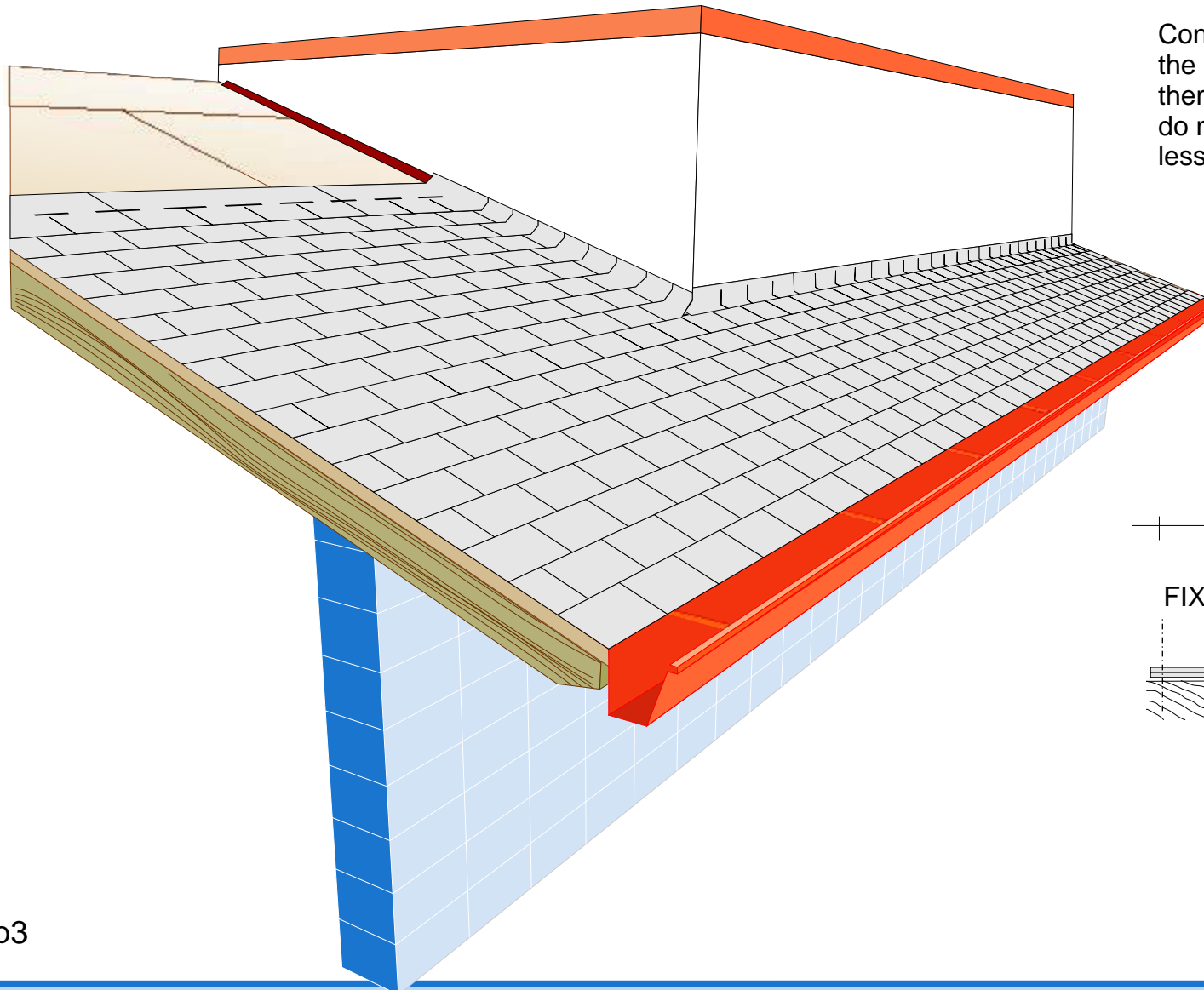

Continue to install the shingles on the pitch and at the corner bent them on wall and fix. On the pitch do not fix with nails at a distance less than at 25 cm from the edge.

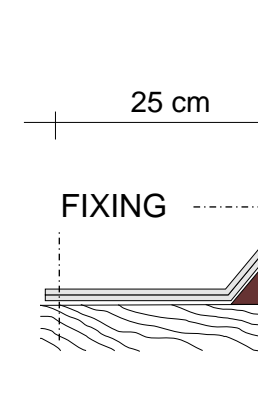

INSTALLATION INSTRUCTION

When the pitch against a sidewall
About flashing around a sidewall

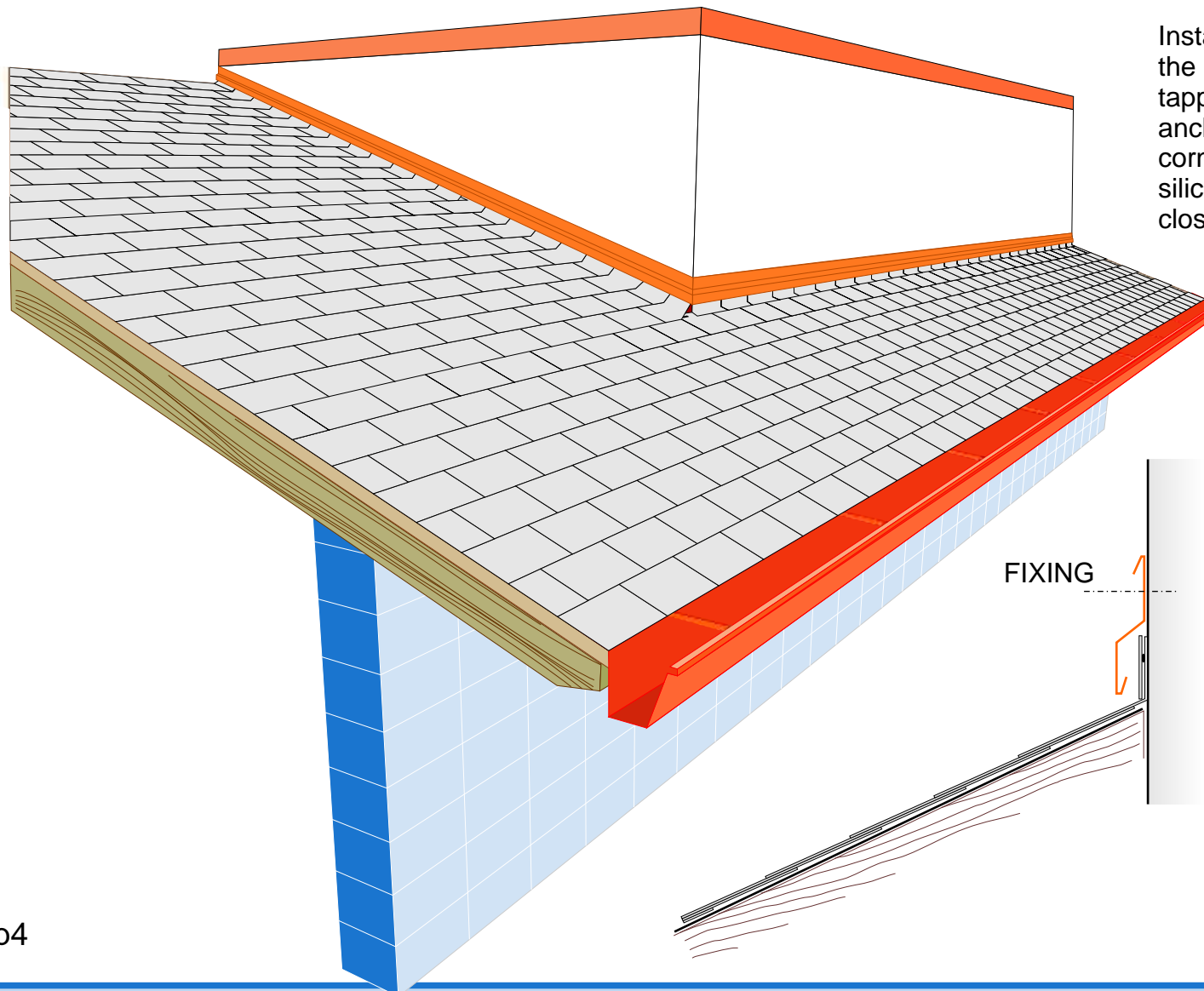

Install the wall metal profile as on the pictures and fix with self-tapping screws for wood or screws anchor. Pay attention on the corner, cut the flashing, bent it, use silicone to waterproof the joint and close the flashing with rivets.

FIXING

FIXING